

OWNERSHIP STATEMENT

We the undersigned, being all parties having any record title interest in the real property being subdivided, do hereby consent to the preparation and recordation of this final map.

As owner: MAMMOTH BRIDGES DEVELOPMENT COMPANY, LLC, a Delaware limited liability company

By: IntraStar Mammoth Bridges Holdings, L.L.C., a Delaware limited liability company, its sole member

By: IntraStar Mammoth, LLC, a Delaware limited liability company, its sole member

By: VI IntraStar Partners, L.L.C., a Delaware limited liability company, managing member

By: VI IntraStar Holdings, L.L.C., a Delaware limited liability company, sole member

By: US/D2 HOLDINGS, L.L.C., a Delaware limited liability company, sole member

By: 

Sign name

SEAN P. ARNOLD, VP
Print name and title

State of California } ss.
County of ~~San Francisco~~

On 12 June 2006 before me,

Hazel Janet Saleesi

a Notary Public in and for said County and State, personally appeared

Sean P. Arnold

☐ personally known to me - OR - ☒ proved to me on the basis of satisfactory evidence to be the person whose name is subscribed to the within instrument and acknowledged to me that he executed the same in his authorized capacity, and that by his signature on the instrument the person, or the entity upon behalf of which the person acted, executed the instrument.

WITNESS my hand and (optional) official seal:

Hazel Janet Saleesi Hazel Janet Saleesi
Notary Public (sign and print name)

My commission expires: 08 JAN 2010

County of my principal place of business: San Francisco

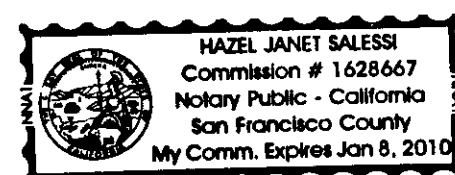
**SIGNATURE OMISSIONS**

The signature of the following parties, their successors and assigns, owners of easements as disclosed by the following deeds recorded in the Official Records of Mono County, have been omitted under the provisions of Section 66436 Subsection a-3A1 of the Subdivision Map Act:

The Bridges Condominium Association

876/001 O.R.

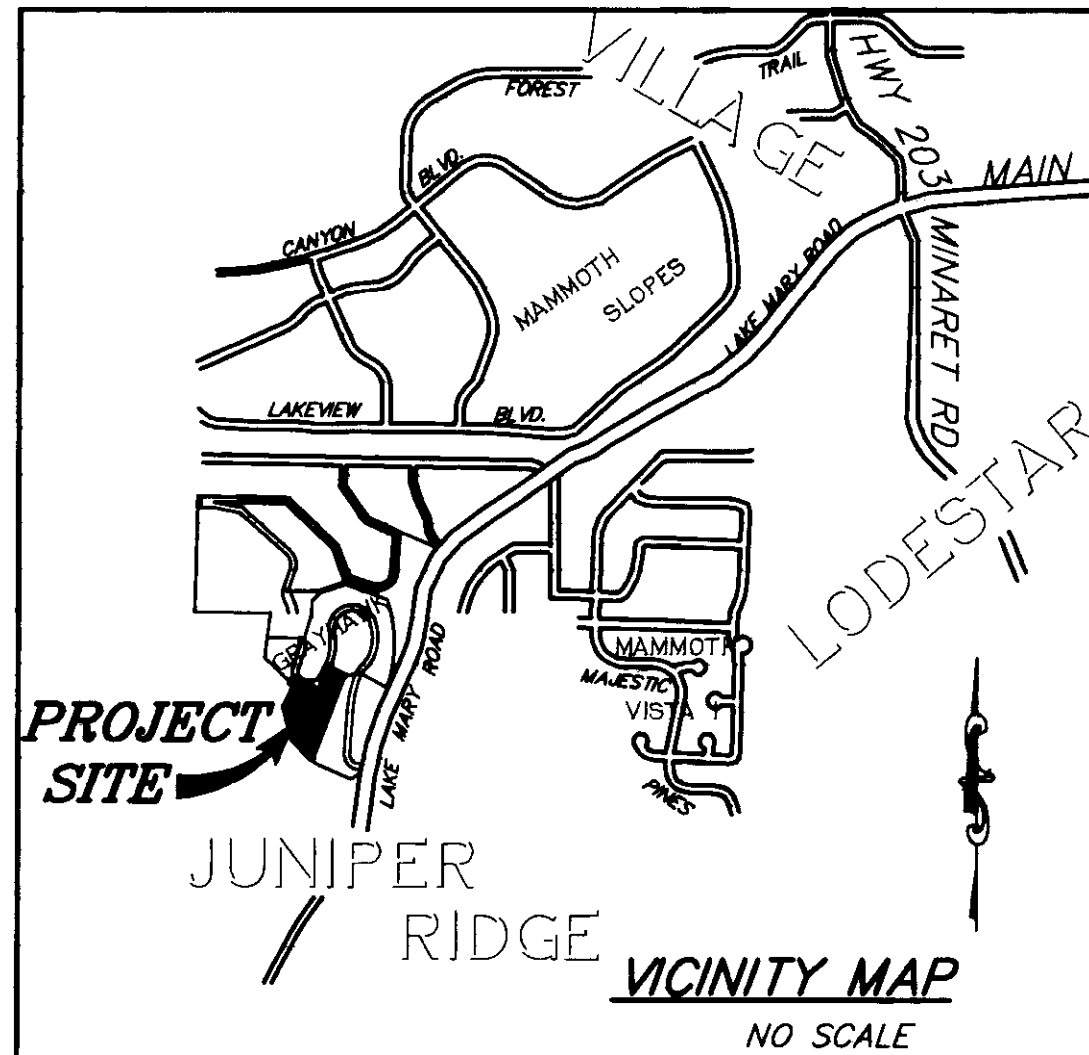

THIS SUBDIVISION IS A CONDOMINIUM PROJECT AS DEFINED IN SECTION 1350 OF THE CIVIL CODE OF THE STATE OF CALIFORNIA, CONTAINING A MAXIMUM OF 23 RESIDENTIAL UNITS AND IS FILED PURSUANT TO THE SUBDIVISION MAP ACT.

SOILS NOTE

A Preliminary Geotechnical Investigation, Project No. 3.30476, dated March 22, 2004, and Amendment dated October 27, 2005 was prepared by Sierra Geotechnical Services, Inc., for Intrawest California Holdings under the signature of Thomas A. Platz, R.C.E. 41039 and Joseph A. Adler, C.E.G. 2198

Said report is on file with the Town of Mammoth Lakes Public Works Department - Engineering Services Division.

C.C. & R.'s NOTE

The Declarations of Covenants, Conditions and Restrictions for Altis Storied Places Mammoth were recorded on 2006 as Instrument No. 2006 of Official Records on file in the office of the Mono County Recorder.

TOWN SURVEYOR'S STATEMENT

This final map was examined by me and I am satisfied that this map is technically correct.

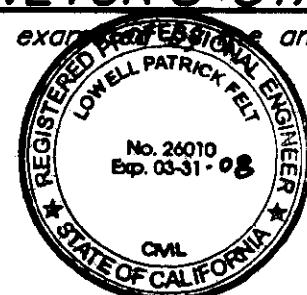

Lowell P. Felt 6/21/06
Lowell P. Felt, RCE 26010 Date
Mammoth Lakes Town Surveyor
License Expires 03/31/08

TOWN ENGINEER'S STATEMENT

This map was examined by me and the subdivision as shown is substantially the same as it appeared on the tentative map and any approved alterations thereof. All provisions of the Subdivision Map Act and any local ordinances applicable at the time of approval of the tentative map have been complied with.



6/21/06
Date

Raymond C. Jarvis
Raymond C. Jarvis (P.E.) C 42318
Mammoth Lakes Town Engineer
Lic. exp.: 3-31-08

RECORDER'S CERTIFICATE

Filed this 5th day of July, 2006 at 11:54 P.M., in Book 10 of Tract Maps at Page 99-99A at the request of IntraStar Mammoth Bridges Holdings.

Instrument No. 2006006010 Fee: \$10.00

Renn Nolan
Mono County Recorder

By: Sherrie A. Hale
Deputy Mono County Recorder

PLANNING COMMISSION'S CERTIFICATE

This final map has been reviewed by the Town of Mammoth Lakes Planning Commission at its meeting of 6-14-06. The Commission found the Final Map to be in substantial conformance with the approved or conditionally approved tentative map and any amendments thereto.

Therefore, in accordance with the provisions of the Town of Mammoth Lakes Ordinance 84-10, Section 17.20.170 as amended by Town of Mammoth Lakes Ordinance 97-06, Section 17.20.170, this Final Map is hereby approved.

BY: Mark Wardlaw
Community Development Department Director

6-27-06
Date

SURVEYOR'S STATEMENT

This final map and survey were prepared by me or under my direction and are based upon a field survey in conformance with the requirements of the Subdivision Map Act and local ordinance performed in October, 2005 at the request of Intrawest California Holdings. I hereby state that this final map substantially conforms to the approved or conditionally approved tentative map. I hereby state that all the monuments are of the character and occupy the positions indicated, or will be set in such positions on or before Sept. 1, 2007, and that such monuments are, or will be, sufficient to enable the survey to be retraced.

June 8 2006
Date

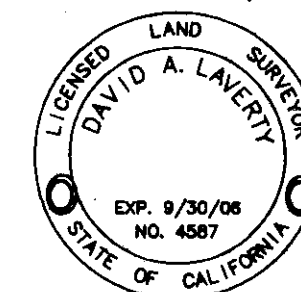

David A. Laverty L.S. 4587
Lic. exp. 9/30/06

TAX COLLECTOR'S CERTIFICATE

I hereby certify that, according to the records on file in this office, there are no liens against this subdivision, or any part thereof, for unpaid state, county, municipal, local taxes or special assessments collected as taxes, except taxes or special assessments not yet payable. Taxes or special assessments collected as taxes which are a lien but not yet payable are estimated to be in the amount of \$ 12,514.99 for which receipt of good and sufficient security conditioned upon payment of these taxes is hereby acknowledged.

Shirley A. Cranney
Mono County Tax Collector

7-5-06
Date

By: [Signature]
Deputy Mono County Tax Collector

ALTIS MAMMOTH
TRACT NO. 36-231
FOR CONDOMINIUM PURPOSES

IN THE TOWN OF MAMMOTH LAKES, MONO COUNTY, CALIFORNIA
BEING A SUBDIVISION OF THE REMAINDER PARCEL OF TRACT NO.
36-189 PER MAP RECORDED IN BOOK 10 OF TRACT MAPS AT
PAGES 58 THROUGH 58C.

GROSS AREA: 3.21± ACRES



SHEET 1 OF 2