

CORNER RECORD

BK 66 PG 84
Document Number CR 6986
County of ALAMEDA, California

City of FREMONT

Brief Legal Description SOUTHWESTERLY LINE OF PARCEL 1, PARCEL MAP 8012 (BK 268 MAPS, PG 68)

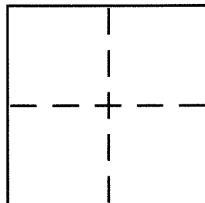

CORNER TYPE

Government Corner ☐ Control ☐
Meander ☐ Property ☒
Rancho ☐ Other ☐
Date of Survey MARCH 13, 2015

COORDINATES (Optional)

N. _____
E. _____
Zone _____ NAD27 ☐ NAD83 ☐
NAD83 Epoch _____
Elev. _____
Vert. Datum: NGVD29 ☐ NAVD88 ☐
Meas. Units: Metric ☐ Imperial ☐

Corner -- Left as found ☐ Found and tagged ☐ Established ☒ Reestablished ☐ Rebuilt ☐

Identification and type of corner found: Evidence used to identify or procedure used to establish or reestablish the corner:

FOUND: 3/4" IRON PIPES WITH PLASTIC PLUG "RCE 25392" ALONG THE NORTHWESTERLY STREET

DEDICATION PER PARCEL MAP 8012 (BK 268 MAPS 68)

SEE SKETCH ON PAGE 2 OF 2

A description of the physical condition of the monument as found and as set or reset:

SET: 1/2" DIAMETER REBAR WITH PLASTIC CAP "PLS 7393", OR 1/2" REBAR WITH 1.5" DIAMETER

ALUMINUM CAP "KEITH NOFIELD PLS 7393" WITH PUNCH.

SEE SKETCH ON PAGE 2 OF 2

SURVEYOR'S STATEMENT

This Corner Record was prepared by me or under my direction in conformance with
the Land Surveyor's Act on MARCH 16, 2015

Signed Keith Nofield P.L.S. or R.C.E. No. PLS 7393

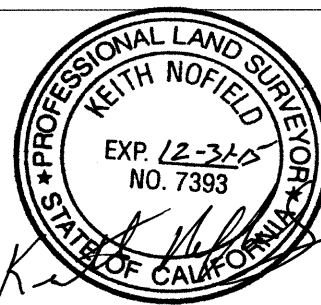

COUNTY SURVEYOR'S STATEMENT

This Corner Record was received 3-17-15
and examined and filed 4-8-15

Signed Russell R. Penland P.L.S. or R.C.E. No. 5726

Title COUNTY SURVEYOR

County Surveyor's Comment _____

