

CORNER RECORD

City of Oakland (APN 48H-7590-92)

Brief Legal Description Monument at intersection of Hiller Drive and Binnacle Hill, near 555 Hiller Drive

BK 74 PG 37

Document Number CR 7831
County of Alameda, California

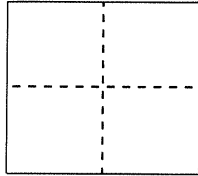

CORNER TYPE

Government Corner ☐ Control ☒
Meander ☐ Property ☐
Rancho ☐ Other ☐

Date of Survey September 1, 2015

COORDINATES (Optional)

N. _____
E. _____
Zone _____ NAD27 ☐ NAD83 ☐
NAD83 Epoch _____
Elev. _____
Vert. Datum: NGVD29 ☐ NAVD88 ☐
Meas. Units: Metric ☐ Imperial ☐

Pre-construction (waterline) Corner Record

Corner - Left as found ☒ Found and tagged ☐ Established ☐ Reestablished ☐ Rebuilt ☐

Identification and type of corner found: Evidence used to identify or procedure used to establish or reestablish the corner:
Found street monument that could be damaged or destroyed due to emergency pipeline repair.

Monument was referenced as shown on page 2. The purpose of this Corner Record is to preserve possible evidence only; no attempt was made to determine the relationship to property, centerline, or right of way lines.

A description of the physical condition of the monument as found and as set or reset:

Monument was found in good condition and was referenced with four set reference points on 9/1/15; representing two intersecting lines as shown on Page 2.

Reference EBMUD Field Book 4561, Pages 58 (Clarke/Chou)

SURVEYOR'S STATEMENT

This Corner Record was prepared by me or under my direction in conformance with
the Professional Land Surveyor's Act on DECEMBER 7, 2015

Signed

James M. Mangini

P.L.S. or R.C.E. No.

7263

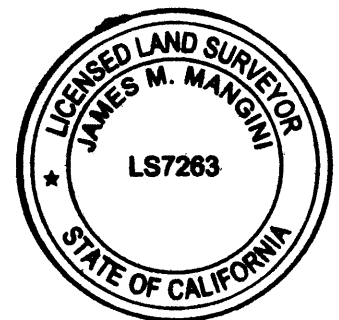

COUNTY SURVEYOR'S STATEMENT

This Corner Record was received 12-09-2015

and examined and filed 12-17-2015

Signed

Albert Jordan

P.L.S. or R.C.E. No.

6623

Title

Deputy County Surveyor

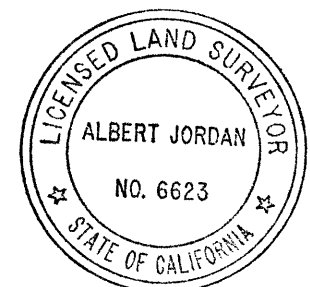

County Surveyor's Comment: _____

OAKLAND

ALAMEDA COUNTY

67 M 1

39

42

BINNACLE
HILL
(PRIVATE)

TRACT 2785

67 M 1

40

43

[99.61']

0.1' FROM RETURN

[101.05']

5' FROM RETURN

[100.00']

60'

[99.43']

4' FROM #557
DRIVEWAY RETURN

32.19'

37.41'

HILLER DRIVE

[102.44']

0.4' FROM #555
DRIVEWAY RETURN

555 HILLER DRIVE
APN 48H-7590-92

PARCEL

B

99

100

TRACT 3721

93 M 66

PARCEL B

LEGEND



FOUND 2-1/2" BRASS DISK WITH PUNCH, DOWN 0.8' IN
STANDARD MONUMENT WELL, 15.5' OFF FACE OF CURB



SET CONCRETE ANCHOR NAIL AND 1-1/2" BRASS WASHER,
STAMPED "EBMUD MON RP" IN TOP CURB (9/1/15)



SET CUT CROSS IN TOP CURB (9/1/15)

SCALE
1"=20'



[] ASSUMED ELEVATION (MEASURED USING A LEICA DNA10 DIGITAL LEVEL)

ADDRESS: 555 HILLER DRIVE
APN: 48H-7590-92

CR# 7831

CR